

AVR-Development Module

Model: AL-AVREB_256

- **Summary**
- **Measures**
- **Description**
- **Electrical Characteristics**
- **Programming**
- **Settings**

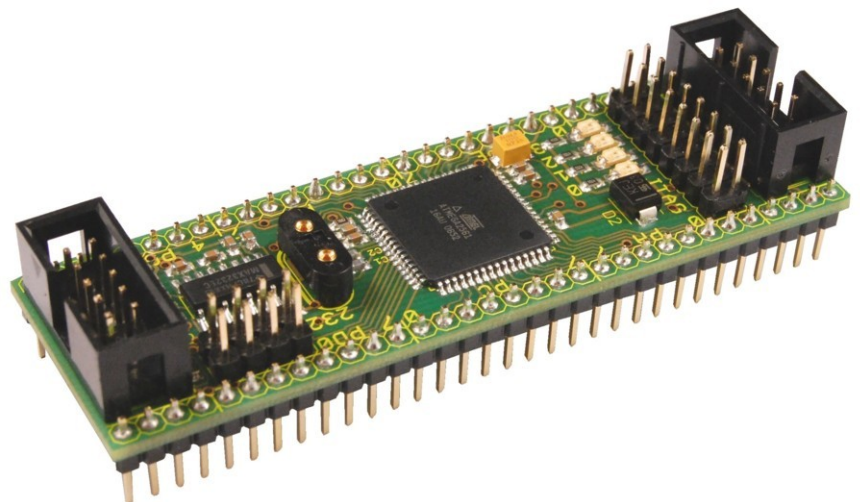

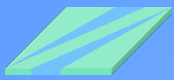

Summary

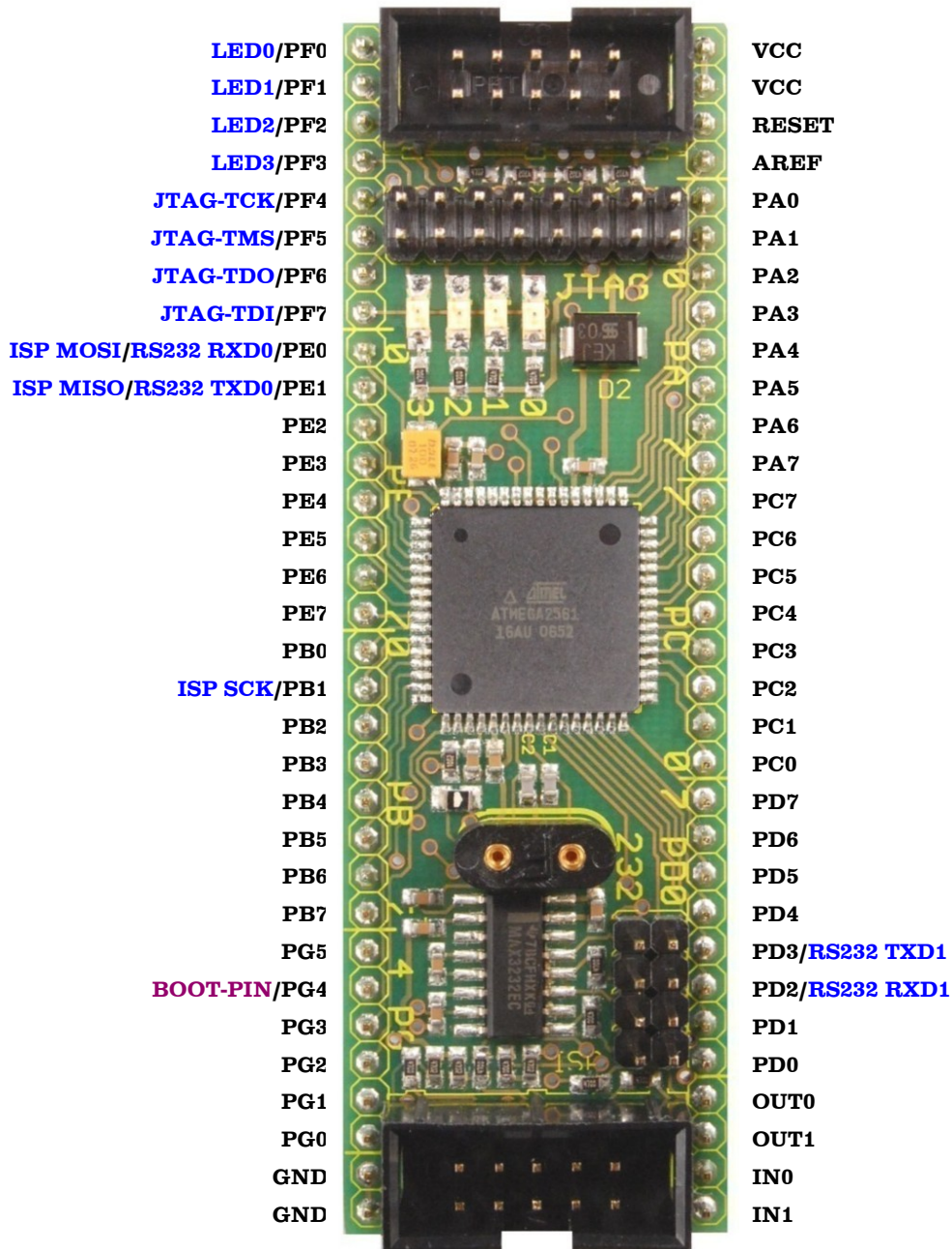

All description in **BLUE** concern the internal connection

Attention! Polarity reversal and overvoltage may cause a destruction of the electronic components!!!

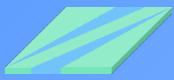

Measures

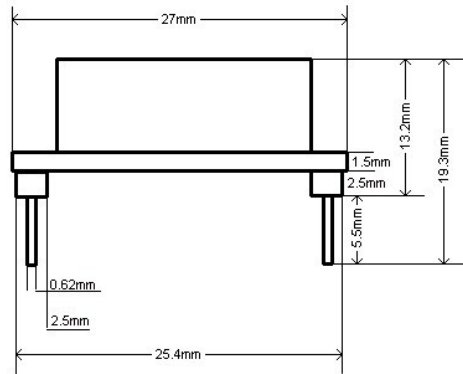
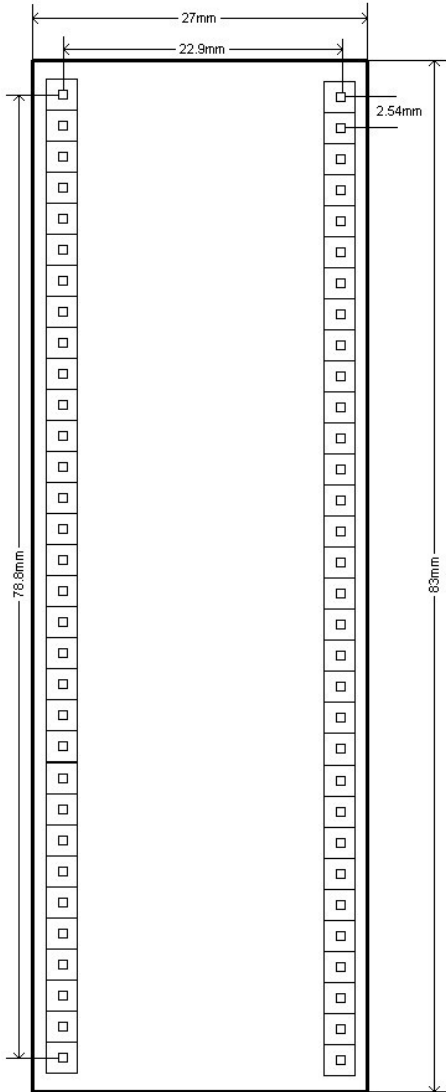

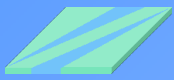

Description

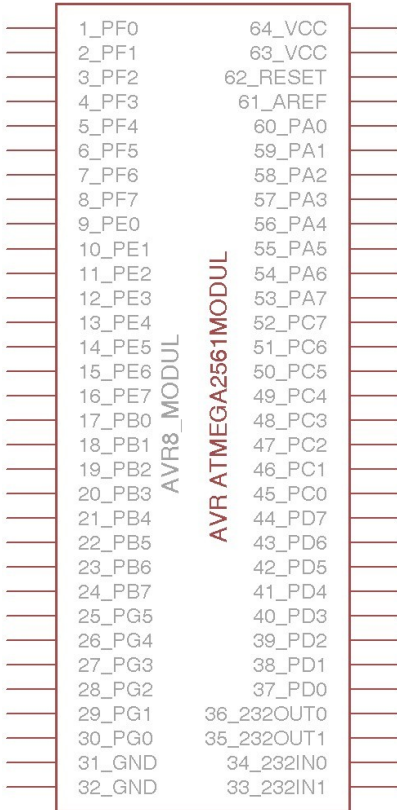

- **Controller:** Atmel AVR ATmega2561-16AU up to 16 MHz
- **Supply voltage:** 5V
- **Module size:** W x H x D 27mm x 83mm x 19.3mm
- **Quartz socket:** simple and fast quartz exchange
- **PC-Connection:** 2 x RS232, separable with jumpers
- **Compatibility:** compatible with IC-Socket 64-pin and hole matrix board
- **Pin-Distance:** 2.54 mm
- **LED:** 4 LEDs, separable with jumpers
- **Circuit:** built on the recommendation of the manufacturer
- **Programming:** ISP or JTAG connector
- **Pin configuration of AVR-Module:** shown at the left picture
- **Pin configuration ISP & JTAG connectors:** 10-pin, standard of Atmel
- **Functionality:** tested, ready for use
- **Conformity:** **RoHS Compliance**
- **Produced** in Germany
- **Description:**

We offer you more flexibility by the development. By means of quartz socket it is possible to choose another frequency easier and faster. IC-Socket makes possible the fast installation of AVR-Module and fits the hole matrix board with the hole distance 2.54 mm. All pins of micro controller are connected with the pins of module and positioned in the logical order, that makes the development work easier. The circuit of the module is built on the recommendation of the manufacturer: A/D converter, reset, ISP, JTAG, RS232, LEDs. Jumper configuration helps you to make the right settings. A suppressor diode is responsible for the security of AVR-Module. We offer you a very simple installation and use of AVR-Module for the beginner as well as for the advancer.

Electrical Characteristics

Min	Typ	Max
-----	-----	-----

for all modules with	Operating Temperature	
MAX3232EID (actual)	- 40 °C	85 °C
MAX3232IDR (actual)		
MAX202ECSE	0 °C	70 °C
MAX3232ECD		

	Operating Voltage	
• with ATmega2561-16AU	4.5 V	5.5 V
• with ATmega2561V-8AU	3.0 V	5.5 V

	Taktfrequenz	
• with ATmega2561-16AU	0 Hz	16 MHz
• with ATmega2561V-8AU	0 Hz	8 MHz

	Maximum DC Current per I/O Pin	
• with ATmega2561-16AU		20 mA
• with ATmega2561V-8AU		10 mA

more electrical characteristics you will find on the page 370 in the data sheet [ATmega2561.pdf](#)

- ▶ Voltage Suppressor P6SMB6.8A
- ▶ 2-layer PCB DIN ISO 9001
- ▶ with UL-Approbation
- ▶ 4x LED yellow 2V 20 mA 140° 39 mcd

Possible Modifications

- with ATmega2561V-8AU
- with mounted quartz (without quartz socket)
- without laterally pins

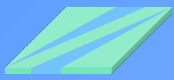

Programming

JTAG ¹

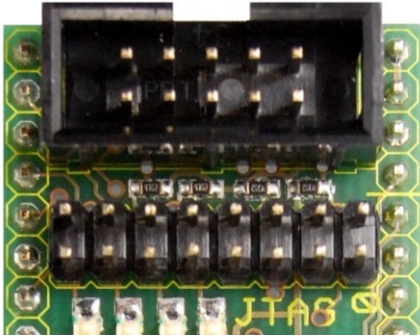

ISP ²

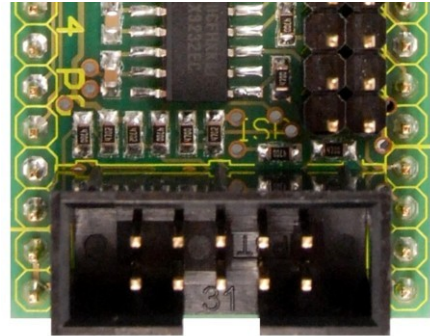

Pin Configuration JTAG-Connector

(9) TDI	(7) VCC	(5) TMS	(3) TDO	(1) TCK
(10) GND	(8)	(6) Reset	(4) VCC	(2) GND

Pin Configuration ISP-Connector

(2) VCC	(4) GND	(6) GND	(8) GND	(10) GND
(1) MOSI	(3) GND	(5) Reset	(7) SCK	(9) MISO

1 When programming with JTAG the JPI-(1-4)-jumpers should be set.

2 When programming with ISP the UART-jumpers JP2-3 and JP2-1 should not be set.

Settings

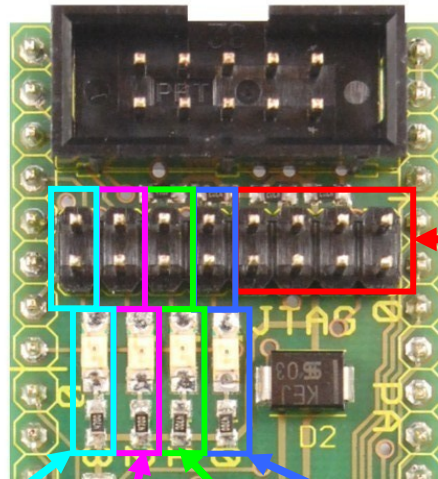

JTAG-jumpers JP1-(1-4)

When programming with JTAG the jumpers should be set in the red square.

<p>LED-jumper 3 +LED 3 (yellow) +resistor</p> <p>Jumper is connected to the pin PF3</p>	<p>LED-jumper 2 +LED 2 (yellow) +resistor</p> <p>Jumper is connected to the pin PF2</p>	<p>LED-jumper 1 +LED 1 (yellow) +resistor</p> <p>Jumper is connected to the pin PF1</p>	<p>LED-jumper 0 +LED 0 (yellow) +resistor</p> <p>Jumper is connected to the pin PF0</p>
--	--	--	--

Jumpers set-up

JP1-8	JP1-7	JP1-6	JP1-5	JP1-4	JP1-3	JP1-2	JP1-1
LED 3 Pin PF3	LED 2 Pin PF2	LED 1 Pin PF1	LED 0 Pin PF0	TDI Pin PF7	TDO Pin PF6	TMS Pin PF5	TCK Pin PF4

Quartz socket

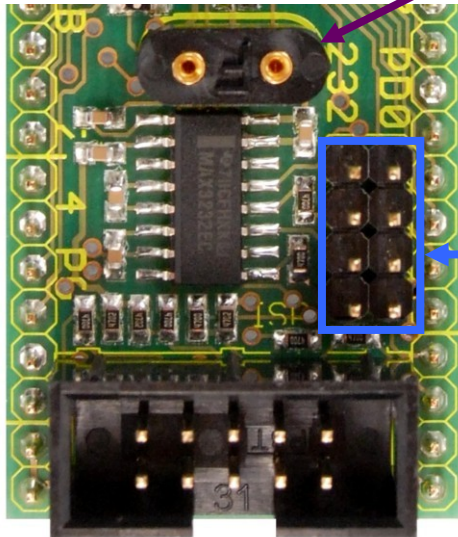

UARTs-jumpers

JP2-4	PD2
JP2-3	PE0
JP2-2	PD3
JP2-1	PE1

The UARTs-pins can be parted from RS232 transceivers with these jumpers.

When programming with ISP the UART-jumpers JP2-3 (PE0) and JP2-1 (PE1) should not be set.

Connection of D-SUB 9-pin female connector (serial port/COM1)

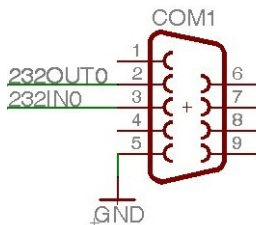

	D-SUB 9-p.	AL-AVREB_256
CH 0 example in the left picture	Pin 2	36_232OUT0
	Pin 3	34_232IN0
	GND	32_GND
CH 1	Pin 2	35_232OUT1
	Pin 3	33_232IN1
	GND	32_GND